



INFINITY POWER PRINCE OUTDOOR LOGO PROJECTOR

A COMPLETE GUIDE PRODUCT CATALOG

www.InfinityProjectors.com

INFINITY POWER PRINCE OUTDOOR LOGO PROJECTOR



JOIN THE GOBO REVOLUTION!

KEY FEATURES



UP TO
50,000
HOURS OF USE



FREE
REMOTE
CONTROL



LOGO
STATIC/SPIN
MODE



FREE
2 GOBOS
FOR EVERY PROJECTORS



EASY
SETUP
INSTALLATION



FREE
SHIPPING

KEY PERFORMANCES



35W - 120W
WATTAGE
Illumination Power



1: 0.33 DEFAULT LENS
AVAILABLE 1:0.2 | 1:0.5 | 1:0.65 | 1:1
for 80W Projectors or Higher



4K HD
PREMIUM QUALITY
Projection



Ip65
WATERPROOF
Outdoor Projectors

INFINITY POWER PRINCE

OUTDOOR LOGO PROJECTORS



PRODUCTS SPECIFICATIONS



OUTDOOR PROJECTORS 35W - 120W

	35 WATT	50 WATT	80 WATT	100 WATT	120 WATT
Luminaire Flux (Lm)	3500	5000	8000	10000	12000
Dimension (cm)	19.3x18x11x8	19.3x18x11x8	19.3x18x11x8	19.3x18x11x8	19.3x18x11x8
Weight (kg)	1.60 kg	1.60 kg	1.60 kg	1.60 kg	1.60 kg
Waterproof	IP 65	IP 65	IP 65	IP 65	IP 65
Projection Distance					
Dark Setting (ft)	6 - 13	10 - 20	13 - 26	16 - 29	16 - 33
Normal Setting (ft)	6 - 10	10 - 13	13 - 20	16 - 28	16 - 26
Very Bright Setting (ft)	0 - 6	0 - 10	0 - 13	0 - 16	0 - 16

OTHER SPECIFICATIONS	DETAILS
Light Source	Osram LED Beads
Light Color	Cold White
Lamp Luminous Efficiency(lm/w)	100
Color Rendering Index(Ra)	80
Input VoltageL AC	85V-265V
Shell Material	Alumunium Alloy
Lens type	Ultra-clear Full Coating Lens
Power supply	Constant Current Power Supply
Cooling system	Aviation Cold Forged Aluminum
Mode Selection	Static / Spin
Single Package	11.8" x 9.84" x 9.84"
Net Weight	3.52lbs.
Standard Lens	1 : 0.33
Alternate Lens	1 : 0.2 1 : 0.5 1 : 0.65 1:1

INFINITY POWER PRINCE

OUTDOOR LOGO PROJECTORS



CHOOSE THE RIGHT WATTAGE



DARK SETTING

Installation Distance (ft)	6'	10'	13'	16'	20'	23'	26'	29'	33'	35'-50'	50'-65'	65'-100'	100'-165'	165'-200'	200'-328'	328'-656'
Recommended Wattage (W)	15W	25W	35W	50W	60W	80W	100W	100W	150W	200W	300W	500W	700W	800W	1000W	1500W



NORMAL LIGHT

Installation Distance (ft)	6'	10'	13'	16'	20'	23'	26'	29'	33'	35'-50'	50'-65'	65'-100'	100'-165'	165'-200'	200'-328'	328'-656'
Recommended Wattage (W)	25W	35W	50W	60W	80W	100W	150W	200W	300W	500W	700W	800W	1000W	1000W	1500W	-



VERY BRIGHT LIGHT

Installation Distance (ft)	6'	10'	13'	16'	20'	23'	26'	29'	33'	35'-50'	50'-65'	65'-100'	100'-165'	165'-200'	200'-328'	328'-656'
Recommended Wattage (W)	35W	50W	60W	80W	100W	150W	200W	300W	500W	700W	800W	1000W	1500W	1500W	-	-

Check out more information on [choosing the right wattages for your gobo projector.](#)

CHOOSE THE RIGHT LENSES

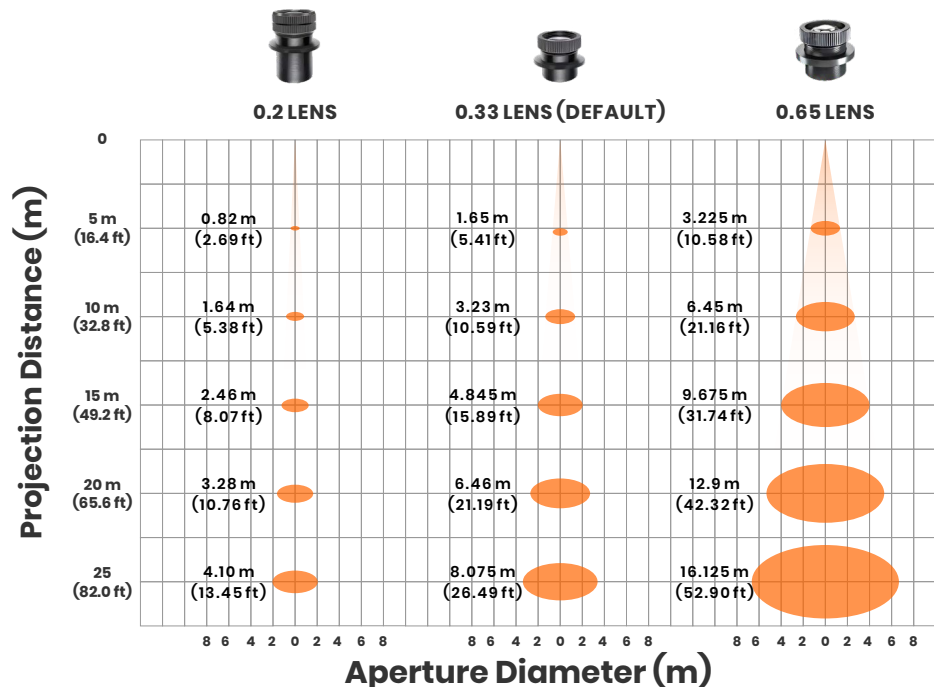

Check out more information on [choosing the right lenses for your gobo projector.](#)

INFINITY POWER PRINCE

OUTDOOR LOGO PROJECTORS



INSTALLATION MANUAL

IMPORTANT NOTES BEFORE USE



To ensure a sharp and clear projection, follow these steps to adjust the focus:

- The product uses a zoom imaging system.
- After receiving the projector, adjust the focus as needed.
- Turn the lens at the front of the projector (a label on the lens indicates adjustment).
- Rotate the lens outward or inward until the logo projection is sharp.

Important:

- For shorter projection distances, rotate the lens outward.
- For longer projection distances, rotate the lens inward.

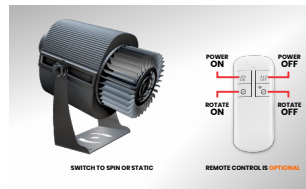

Adjust The Logo To Spin or Static

There is a switch at the rear of the lamp .Press the switch to spin or static.

Remote control function also available, it can control the logo to spin or static, and turn on and off the projector light.

PROJECTOR INSTALLATION

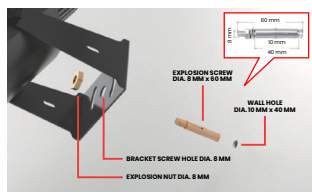

PREPARATION

1. Drill screw holes in the positions to be installed
Dia.10 mm x Depth 40 mm
2. Put the explosion screw into the punched hole first
3. Align the screw hole of the machine base bracket into the threaded end of explosion screw.



INSTALLATION

Screw the M8 nut into the thread at the end of the explosion screw until it is tightened and the installation is completed.

REPLACING GOBO METHOD



STEP 1

Screw out all the screws of the front cover of the machine.



STEP 2

Take out the spring on the GOBO and then take out the GOBO

Note: a little soft glue will be applied to install the gobo that you received, and no glue is needed when replave or reinstall gobo, only the spring is needed to clamp the gobo.



STEP 3

- Take the gobo out and replacee with new gobo
- Make sure the new gobo are clean from dust and other particles
- Insert the new gobo, Ensuring the "REVERSE SIDE" is facing up.
- Secure it with the snap ring.



STEP4

Reinstall the projector front cover and make sure the bolts are tightly installed.

REPLACEMENT COMPLETE! Enjoy Your New Projector



INFINITY POWER PRINCE

OUTDOOR LOGO PROJECTORS



FREE!

1 PCS ONE-COLOR GOBO



FREE!

1 PCS FULL-COLOR GOBO

ONE-COLOR GOBO COLOR SWATCH

Our standard one-color gobos come in a variety of swatches for direct selection.

LIGHT GREEN	DARK GREEN	GRASS GREEN	LIGHT BLUE
SKY BLUE	MEDIUM BLUE	BLUE	VIOLET BLUE
PURPLE	FUSCHIA	LIGHT PINK	PINK
RED	DARK RED	ORANGE RED	ORANGE
LIGHT ORANGE	YELLOW	COFFEE RED	BROWN
	BLACK	LIGHT GREY	

ONE-COLOR GOBO BASED ON COLOR SWATCH



FULL-COLOR GOBO FREE COLOR OF YOUR LOGO



Note: Art requiring a different shade of the color available in our swatch is considered a **full color** gobo

[View Stock Gobo](#)

INSTALLATION GUIDE

PROJECTOR LENSES



[View Video](#)

PROJECTION ANGLES



[View Video](#)



VISIT OUR BLOG FOR MORE INSPIRATION & INFORMATION



A COMPLETE GUIDE TO BUYING LOGO PROJECTORS

Choosing the right logo projector is crucial for delivering crisp, impactful projections, whether for branding, safety, or creative displays.

[Visit Blog](#)

STATIC VS SPIN LOGO FOR YOUR BUSINESS

The choice between a spin or static 4 Gobo projector is about matching functionality with objective. What will you choose to amplify your business's voice?

[Visit Blog](#)

PROJECTION ANGLE & LENS GUIDE

We are here to guide you through selecting the ideal lens for your projector needs, ensuring the perfect projection size for your setting.

[Visit Blog](#)

BLACK COLOR IN CUSTOM GOBO ART: RULES, EXAMPLES, AND DESIGN TIPS

Black behaves differently than other colors—it blocks light, causing it to not project. This guide will explain when black works, when it doesn't, how to handle black in logos, and tips for designing gobos that project clearly and beautifully.

[Visit Blog](#)